

1 TO 1 RATIO

2 TO 1 RATIO

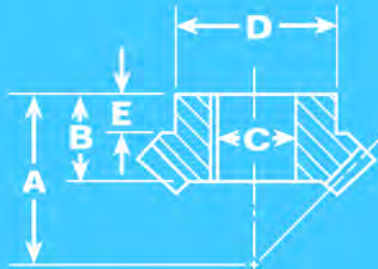

Figure 22

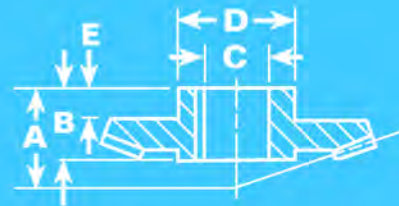

Figure 23

| Part No. | 35GT35L35 | 35GT35R35 | 40GT35L35 | 40GT35R35 | 50GT35L35 | 50GT35R35 | 60GT35L35 | 60GT35R35 | 45GT46L23 | 45GT23R46 | 54GT40L20 | 54GT20R40 | 67GT46L23 | 67GT23R46 |
|-------------------------|---|-----------|--|-----------|--|-----------|--|-----------|---|-----------|--|-----------|---|-----------|
| | 22 | 22 | 22 | 22 | 22 | 22 | 22 | 22 | 22 | 23 | 22 | 23 | 22 | 23 |
| Gear | | | | | | | | | | | | | | |
| Outside Dia. | 3.560 | | 4.075 | | 5.110 | | 6.144 | | 4.518 | | 5.446 | | 6.664 | |
| Pitch Dia. | 3.500 | | 4.000 | | 5.000 | | 6.000 | | 4.500 | | 5.429 | | 6.667 | |
| Pinion | | | | | | | | | | | | | | |
| Outside Dia. | 3.560 | | 4.075 | | 5.110 | | 6.144 | | 2.424 | | 2.935 | | 3.596 | |
| Pitch Dia. | 3.500 | | 4.000 | | 5.000 | | 6.000 | | 2.250 | | 2.714 | | 3.333 | |
| Combination | 35 | 35 | 35 | 35 | 35 | 35 | 35 | 35 | 23 | 46 | 20 | 40 | 23 | 46 |
| Diametral Pitch | 10 | | 8.75 | | 7 | | 5.833 | | 10.222 | | 7.368 | | 6.9 | |
| Face Width | 1 ¹³ / ₁₆ | | 1 | | 1 ³ / ₁₆ | | 1 ⁵ / ₁₆ | | 1 ³ / ₁₆ | | 1 | | 1 ³ / ₁₆ | |
| A Mount Dist. | 2 ⁹ / ₁₆ | | 2 ¹³ / ₁₆ | | 3 ⁷ / ₁₆ | | 4 ¹ / ₈ | | 2 ⁹ / ₁₆ 2 ¹ / ₁₆ | | 3 2 ⁷ / ₁₆ | | 3 ¹¹ / ₁₆ 2 ¹⁵ / ₁₆ | |
| B Bore Length | 1 ¹ / ₄ | | 1 ³ / ₈ | | 1 ⁵ / ₈ | | 1 ⁷ / ₈ | | 1 1 ³ / ₈ | | 1 ¹ / ₈ 1 ⁵ / ₈ | | 1 ³ / ₈ 1 ⁷ / ₈ | |
| C Bore Dia. | 1 ³ / ₁₆ | | 1 ⁵ / ₁₆ | | 1 ⁷ / ₁₆ | | 1 ¹¹ / ₁₆ | | 7 ⁷ / ₈ 1 ⁵ / ₁₆ | | 1 ¹ / ₁₆ 1 ⁷ / ₁₆ | | 1 ⁵ / ₁₆ 1 ¹¹ / ₁₆ | |
| D Hub Dia. | 2 ¹ / ₂ | | 2 ³ / ₄ | | 3 ¹ / ₄ | | 3 ⁵ / ₈ | | 1 ³ / ₄ 2 ¹ / ₂ | | 2 ¹ / ₈ 2 ⁷ / ₈ | | 2 ³ / ₄ 3 ¹ / ₈ | |
| E Hub Length | 9 ⁹ / ₁₆ | | 9 ⁹ / ₁₆ | | 9 ⁹ / ₁₆ | | 3 ³ / ₄ | | 1 ¹ / ₄ 9 ⁹ / ₁₆ | | 3 ³ / ₁₆ 5 ⁵ / ₈ | | 9 ⁹ / ₃₂ 1 ¹³ / ₁₆ | |
| Keyway | 1 ¹ / ₄ x3 ³ / ₃₂ | | 3 ³ / ₈ x1 ¹ / ₈ | | 3 ³ / ₈ x1 ¹ / ₈ | | 3 ³ / ₈ x1 ¹ / ₈ | | 3 ³ / ₁₆ x1 ¹ / ₁₆ 3 ³ / ₈ x1 ¹ / ₈ | | 1 ¹ / ₄ x3 ³ / ₃₂ 3 ³ / ₈ x1 ¹ / ₈ | | 3 ³ / ₈ x1 ¹ / ₈ 3 ³ / ₈ x1 ¹ / ₈ | |
| *Max. Bore | 1 ¹¹ / ₁₆ | | 1 ⁷ / ₈ | | 2 ¹ / ₂ | | 2 ³ / ₄ | | 1 1 ¹ / ₂ | | 1 ³ / ₁₆ 2 | | 1 ⁵ / ₈ 2 ¹ / ₄ | |
| Wt. each, lbs. | 1.88 | | 2.69 | | 5.25 | | 8.25 | | .62 2.87 | | 1.00 5.00 | | 2.00 8.00 | |
| Torque (lb. in.) | Gear | 1807 | 2809 | 4929 | 7496 | | | | | 2300 | | 3922 | | 6686 |
| | Pinion | 1807 | 2809 | 4929 | 7496 | 1150 | | | | | 1961 | | 3343 | |

Note: All dimensions are in inches.

*Keyway Unchanged.